

## INSTRUCTION FOR SERVICING SPRAY NOZZLE:

**The entire working parts of the Strahman Mini M-70 Lightweight Spray Nozzle are contained in a Single Cartridge Unit. CAUTION: Not for use on steam hose.**

### To replace cartridge:

1. Remove the **Rubber Cover (20)** by slipping it off the back of the nozzle and pulling it over the front using a round tool: not a sharp tool that can cut cover.
2. Remove the **Lever Arm Screw & Nut (24)** and the **Lever Arm (6)**.
3. **Unscrew Lock Screw (30)** and extract the cartridge from back end of nozzle with **Cage (18)**.
4. Be sure when replacing **Cage (18)** to place cut-away part of cage facing downward, so **Lever Arm (6)** can be inserted.
5. To insert new cartridge, reverse procedure beginning.
6. Be sure **Lever Arm (6)** is placed ahead of **Stem Guide (31)** on cartridge unit.
7. To replace **Rubber Cover (20)** wipe body with detergent, insert nozzle end first then handle into cover. Use a round ended tool approx. 3/8" in diameter to stretch cover over back. Do not use sharp tool. Sharp tools can cut cover.



ESTABLISHED 1921

STRAHMANVALVES.COM

WORLD HEADQUARTERS  
STRAHMAN VALVES, INC.

2801 BAGLYOS CIRCLE, BETHLEHEM, PA 18020

P: +1 484.893.5080 F: +1 484.893.5099 E: STRAHMAN@STRAHMAN.COM

UNITED STATES • FRANCE • GERMANY • CHINA • HONG KONG



ISO 9001  
OHM-Global



WDEMINIM70ASSY062020

## MINI M-70 SERIES

Assembly Instructions for Series—  
MINI M-70 | MINI M-75 | MINI S-70 | MINI S-75



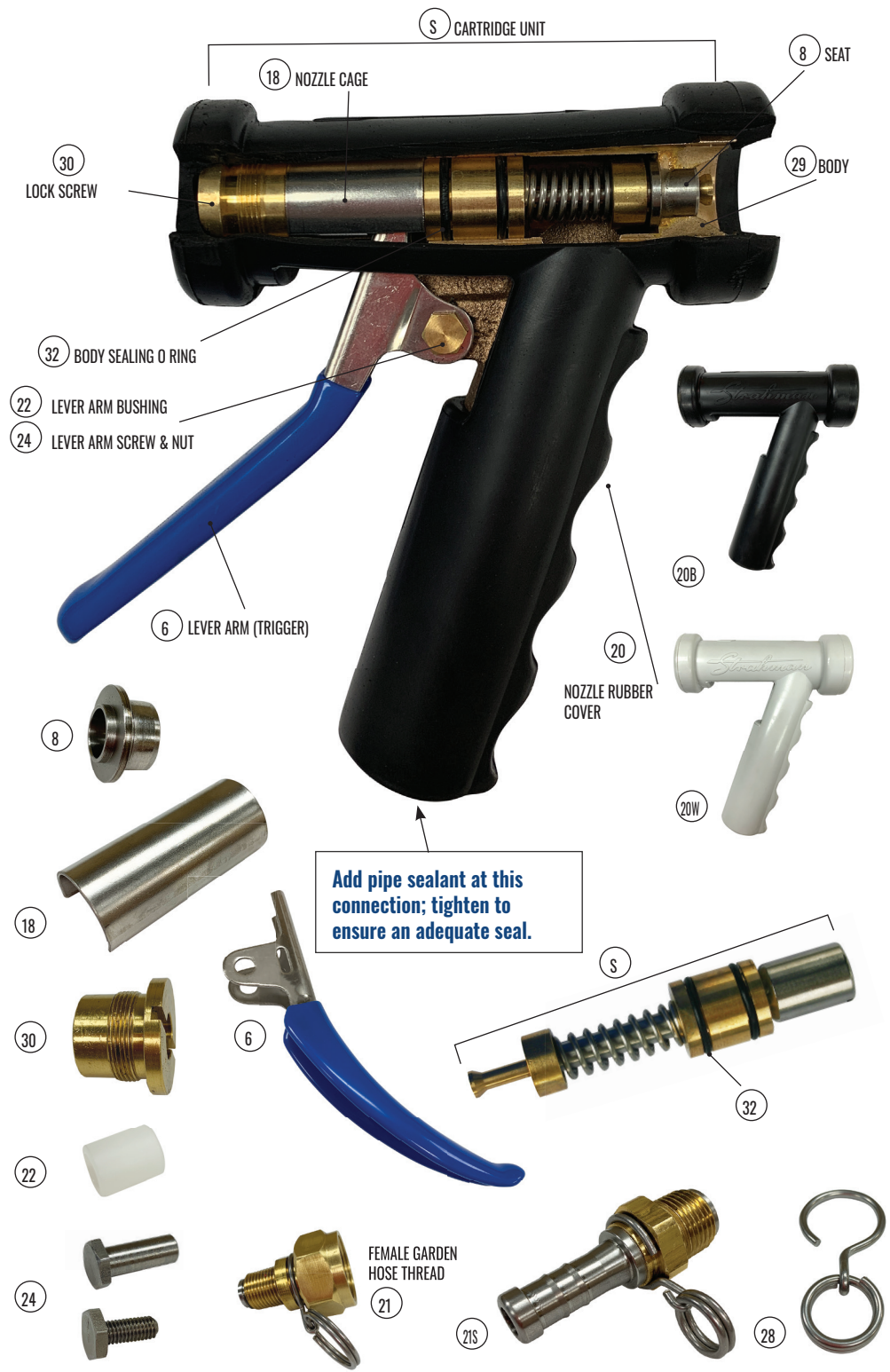

PARTS LIST						
ITEM NO.	ORDER NUMBER	DESCRIPTION	MINI M-70	MINI M-75	MINI S-70	MINI S-75
8	M7MSEAT	SEAT, SS 303	✓	✓	✓	✓
18	M7MCAGE	MINI NOZZLE CAGE, SS 304	✓	✓	✓	✓
30	M7MSCAP	LOCK SCREW, BR C3600	✓		✓	
22	M7MBU	MINI LEVER ARM BUSHING NYLON	✓	✓	✓	✓
24	M7MLSCRSS	MINI LEVER ARM SCREW, SS 303			✓	✓
	M7MLSCR	MINI LEVER ARM SCREW, BRONZE	✓	✓		
	M7MLNUT	MINI LEVER ARM NUT, SS 303	✓	✓	✓	✓
6	M7MLARMC	LEVER ARM - BLUE (BL)	✓	✓	✓	✓
29	M7MBDF	BODY, BRASS C83600	✓	✓		
	M7MBDSS	BODY, STAINLESS STEEL 304			✓	✓
20	M7MCOVRBLACK	NOZZLE RUBBER COVER - BLACK (B)	✓	✓	✓	✓
	M7MCOVRWHITE	NOZZLE RUBBER COVER - BLACK (W)	✓	✓	✓	✓
ADAPTER PARTS						
21	MINISWLO075GSS	¾" MINI GHT SWIVEL HOSE ADAPTER, SST	✓	✓		
21S	MINISWLO500SS	½" MINI SWIVEL ADAPTER, SST	✓	✓		
	MINISWLO063SS	⅝" MINI SWIVEL ADAPTER, SST	✓	✓		
	MINISWLO075SS	¾" MINI SWIVEL ADAPTER, SST	✓	✓		
21	MINISWLO075GBR	¾" MINI GHT SWIVEL HOSE ADAPTER, BRONZE			✓	✓
21S	MINISWLO500BR	½" MINI SWIVEL ADAPTER, BRONZE			✓	✓
	MINISWLO063BR	⅝" MINI SWIVEL ADAPTER, BRONZE			✓	✓
	MINISWLO075BR	¾" MINI SWIVEL ADAPTER, BRONZE			✓	✓
28	M7MLRNG	MINI LOCK RING, SS302	✓	✓	✓	✓
	HADAP00380050B	MINI ADAPTER TO STRAHMAN HOSE - BRONZE (NOT SHOWN)	✓	✓		
	HADAP00380050SS	MINI ADAPTER TO STRAHMAN HOSE, SST (NOT SHOWN)			✓	✓
REPLACEABLE CARTRIDGE UNIT						
S	M7MCART	MINI NOZZLE CARTRIDGE, BRASS	✓	✓		
	M7MCARTSS	MINI NOZZLE CARTRIDGE, SST			✓	✓
31	STEM GUIDE (INSTALLED WITH CARTRIDGE) (NOT SHOWN)		✓	✓	✓	✓
28	BODY SEALING O RING (INSTALLED W/CARTRIDGE)		✓	✓	✓	✓